



FEATURES  
BROCHURE

enovis™

# PECA<sup>®</sup> COMPRESSIVE

Ø4 BEVELED COMPRESSIVE IMPLANTS

SCREW SYSTEMS



# KEY FEATURES

Peca® Compressive Implants are intended for the fixation of osteotomy and arthrodesis of the foot. The cannulated, titanium alloy TA6V ELI implant is equipped with a beveled head and partially threaded cutting flutes allow compression by seating flush with the near cortex, preserving soft tissue structures.

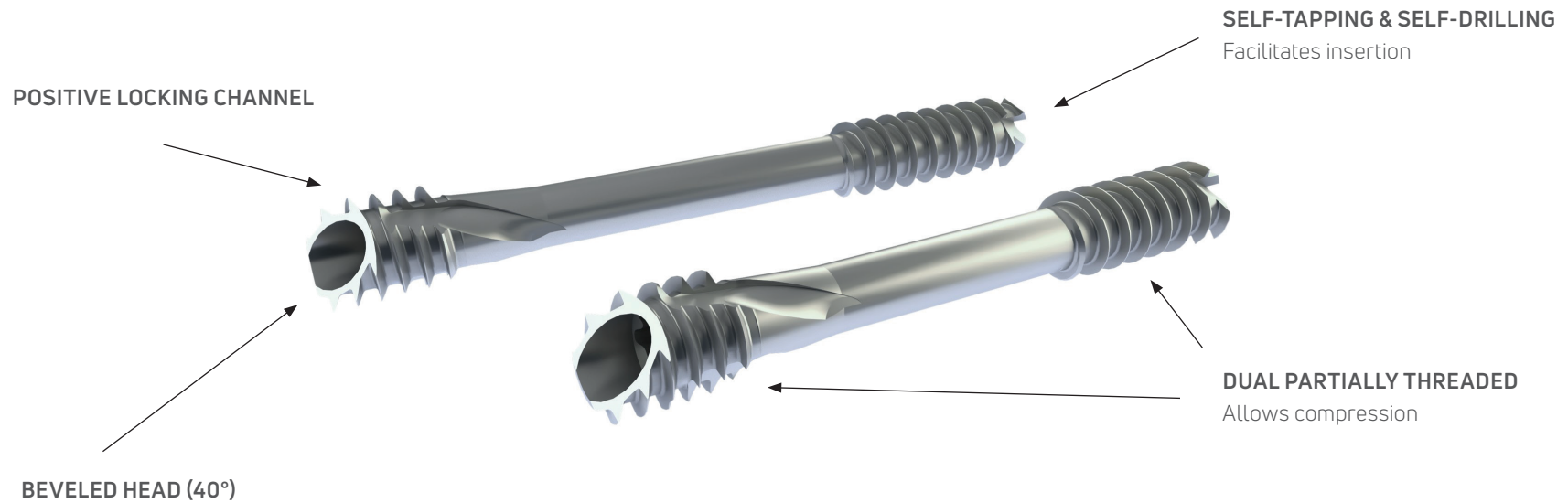

# BEVELED DESIGN



## **BEVELED HEAD**

Cortical anchorage maximization and soft tissues preservation

VS

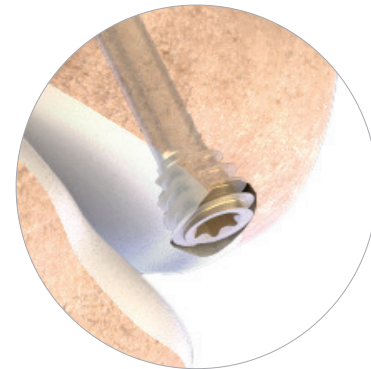

## **STANDARD HEAD**

Compromise between burial of the head and cortical anchorage

# EXACT-T<sup>®</sup> RECESS

Allows exact beveled implant head positioning. The driver is designed to achieve exact positioning of the screwdriver tip in one position only.

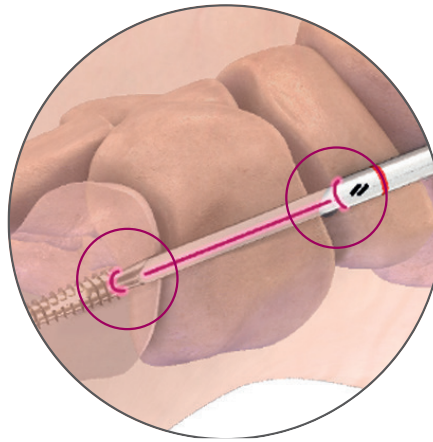

# MULTIPLE INDICATIONS

The osteosynthesis screws are indicated for arthrosis, hallux valgus and other bone alignment defaults (pes cavus, flatfoot, calcaneal valgus, malalignment secondary to previous trauma). PECA® Compressive screws can be used for arthrodesis in the midfoot, metatarsal and phalangeal bones of the foot, either alone or in combination with an Airlock® plate.

## TRADITIONAL SURGERY



MTP



TALO-NAVICULAR

## PERCUTANEOUS SURGERY

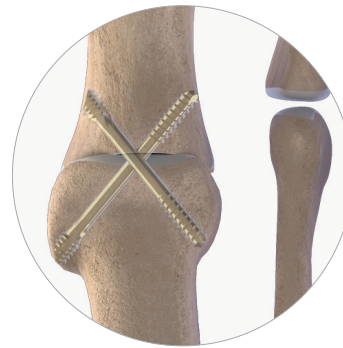

MTP

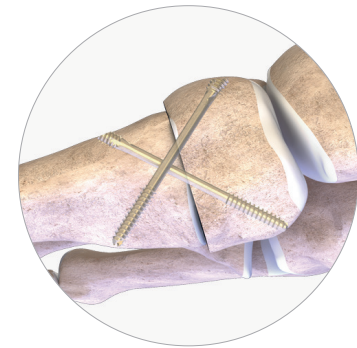

LAPIDUS



MTP ARTHRODESIS POST-OP



MTP ARTHRODESIS POST-OP

# DEDICATED INSTRUMENTATION

Ø 4mm PECA® Compressive implant can be used:

- With PECA® set, with the optional addition of a countersink;
- With AIRLOCK® set, with the addition of PECA® Compressive instruments.

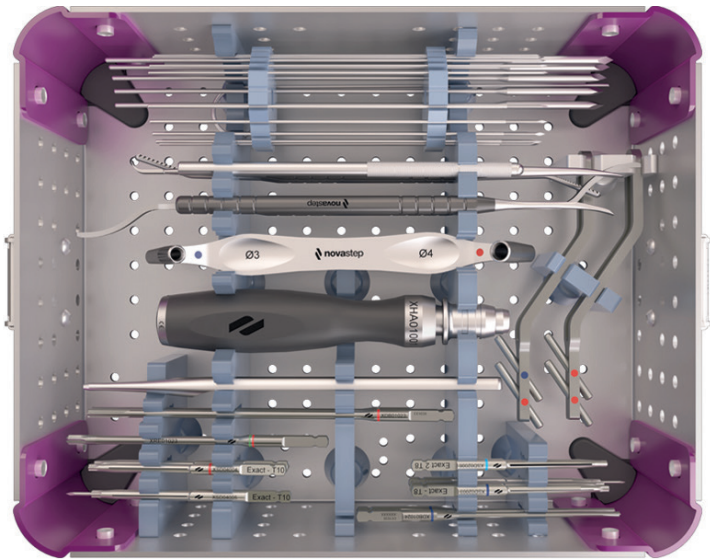

PECA® SET

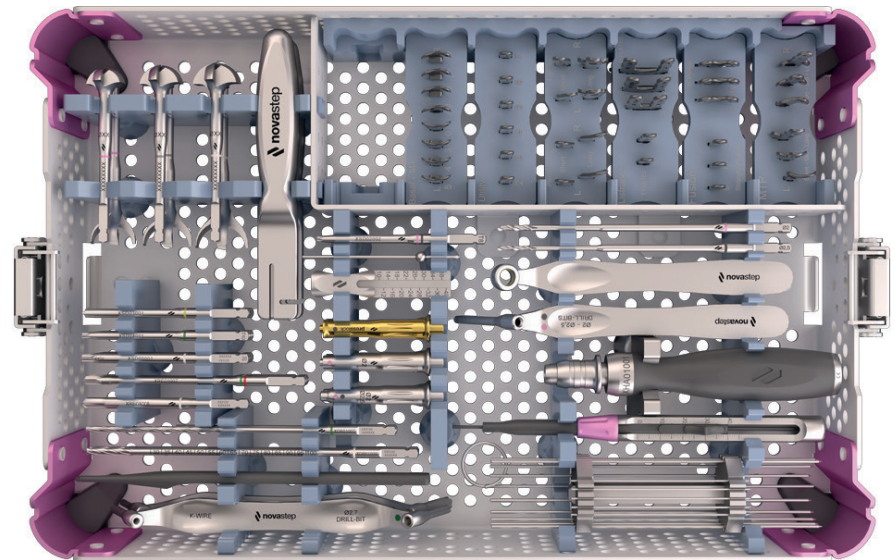

AIRLOCK® SET

# REFERENCES

## PECA® COMPRESSIVE IMPLANTS

LENGTH	REFERENCE
18mm	PS050118
20mm	PS050120
22mm	PS050122
24mm	PS050124
26mm	PS050126
28mm	PS050128
30mm	PS050130
32mm	PS050132
34mm	PS050134
36mm	PS050136
38mm	PS050138
40mm	PS050140
42mm	PS050142
44mm	PS050144
46mm	PS050146
48mm	PS050148
50mm	PS050150
55mm	PS050155
60mm	PS050160

## PECA® COMPRESSIVE SPECIFIC INSTRUMENTS

REFERENCE	DESCRIPTION
CKW02005 <sup>(1)</sup>	K-WIRE Ø1.4 LG 150 TR/RD CRCO
XDB01018	AO DRILL BIT Ø3.2
XSD04004	EXACT-T® 10 AO SCREWDRIVER TIP
XGA01009	RULER LG 150
XRE01007 <sup>(2)</sup>	COUNTERSINK Ø3.7 - NEXIS®/PECA®-C

<sup>(1)</sup> K-wire supplied separately

<sup>(2)</sup> Optional

**enovis.**

T +33 (0) 2 99 33 86 50 F +33 (0) 9 70 29 18 95

Legal manufacturer: Novastep® S.A.S  
2 Allée Jacques Frimot | 35000 Rennes | France  
contact-intfa@enovis.com  
www.int.novastep.life

Copyright © 2024 Enovis Foot and Ankle

*Carefully read the enclosed Instructions For Use (IFU) and all packaging label information. Devices: Implants: Class IIb-CE1639 / Instruments: Class I / Class Ir-CE1639 / Class IIa-CE1639.*

REFERENCE: PECA-C-L-ED2.1-06-25-EN